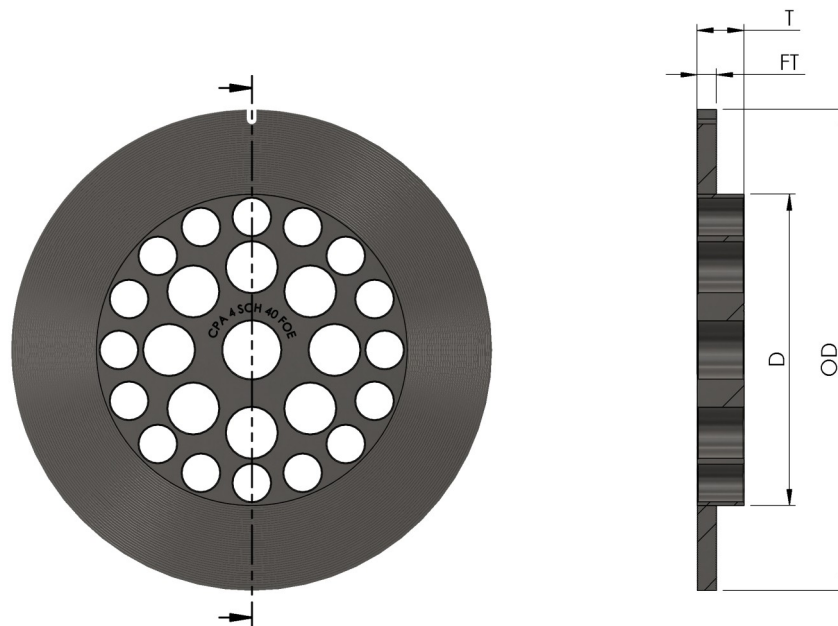

**CPA 50E | Type A Flow Conditioner | Dimensional Information**

NPS	Schedule	Insertion Diameter (D)	Flange Diameter (OD)	Thickness (T)	Flange Thickness (FT)	CPA 50E Weight (lbs)
2"	40	2.047	3.625	0.500	0.125	0.40
	80	1.919	3.625	0.500	0.125	0.39
3"	40	3.048	5.000	0.640	0.250	1.35
	80	2.880	5.000	0.640	0.250	1.33
4"	40	4.006	6.190	0.604	0.250	2.40
	80	3.806	6.190	0.574	0.250	2.32
6"	40	6.045	8.500	0.910	0.250	5.93
	80	5.741	8.500	0.864	0.250	5.57
8"	40	7.941	10.620	1.197	0.375	13.06
	80	7.585	10.620	1.144	0.375	11.94
10"	40	9.980	12.750	1.503	0.375	22.90
	80	9.524	12.750	1.435	0.375	21.36
12"	40	11.898	15.000	1.791	0.375	36.85
	80	11.336	15.000	1.706	0.375	33.94
16"	40	14.920	18.500	2.250	0.500	72.13
	80	14.234	18.500	2.147	0.500	66.68
20"	40	18.734	23.000	2.822	0.750	146.33
	80	17.858	23.000	2.691	0.750	136.24
24"	40	22.546	27.250	3.394	0.750	242.25
30"	40	28.420	33.750	4.275	1.000	480.81
36"	40	34.420	40.250	5.175	1.500	869.05

All dimensions are in inches. Weight calculated using 316SS. Custom sizes are available, please contact CPA for more information!

Canada Pipeline Accessories | 1-888-349-3569 | [www.flowconditioner.com](http://www.flowconditioner.com)

The design, performance and compliance data available is only applicable to the CPA 50E Flow Conditioner. Such data is considered proprietary and may not be used or copied without Canada Pipeline Accessories' written permission. In addition, Canada Pipeline Accessories, CPA 50E, CPA, 50E, FloAlign and FloCoat are registered trademarks owned by Canada Pipeline Accessories.